

# C6a

# Order Guide

- 01 Before Ordering
- 02 Order Chain
- 03 Estimate Request
- 04 Price Estimate
- 05 Panel Project
- 06 Detailed Offer
- 07 Purchase Agreement
- 08 Included Materials
- 09 Lead Time

# To consider before ordering

## Energy class A+

When accounting for the cost of both materials and labor, the cost of EcoCocon wall per 1 m<sup>2</sup> is comparable to other construction systems with similar energy efficiency.

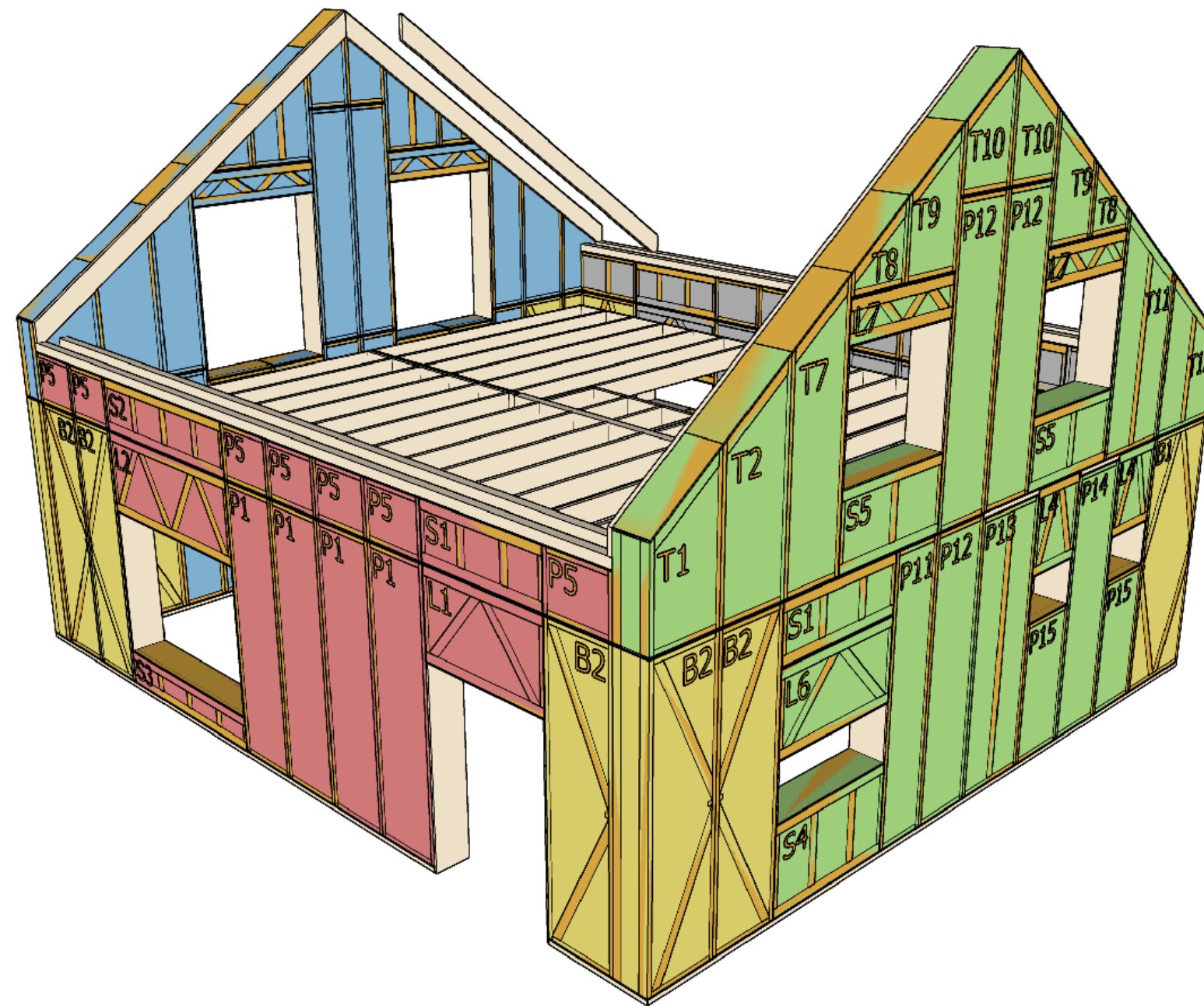

## Design

EcoCocon panels are designed to fit your existing design.

## Assembly

One storey per day with 3-4 people possible if crane on site.

## Transport

Calculated separately for each delivery.

# Order chain

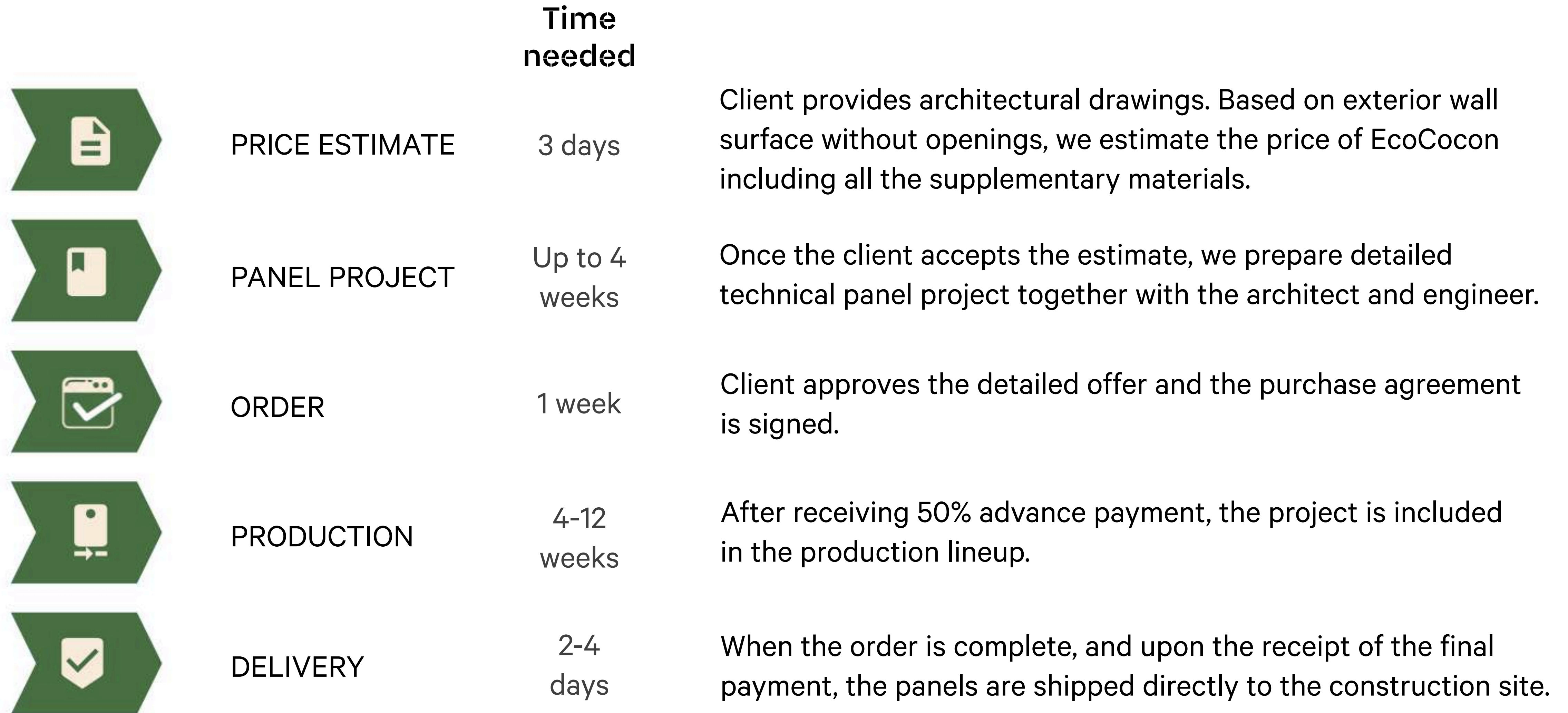



# Estimate request

You might need to estimate the cost of a building after creating a study of the planned house. Or you have planning permission drawings and wonder how much the EcoCocon system would cost.

- » Send us drawings, ideally in DWG (PDF or Sketchup are also acceptable). We need floor plans, sections and elevations .

## Note

- » The drawings have to be in scale and with sufficient measurements
- » Indicate clearly which parts are supposed to be built with EcoCocon

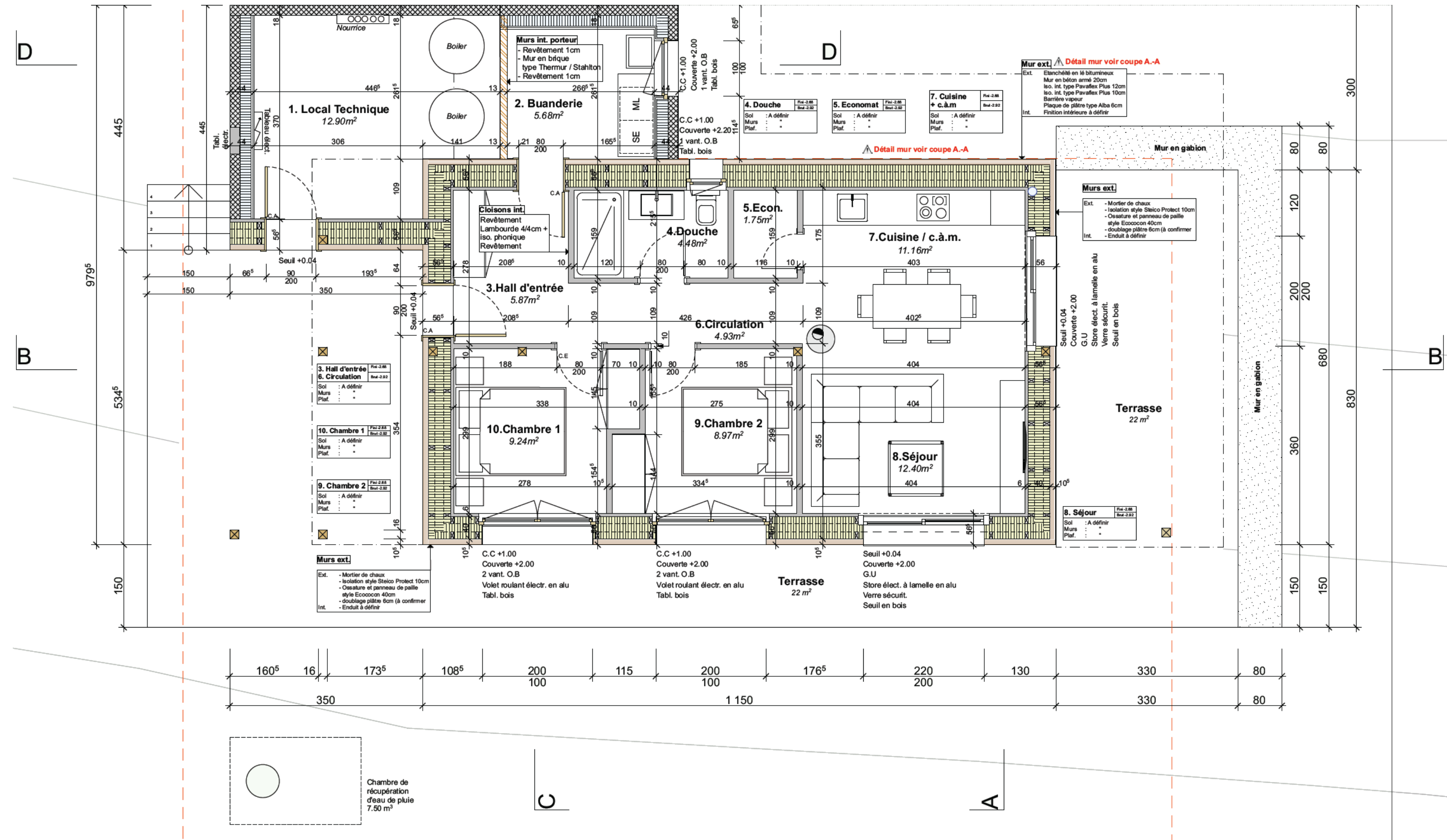

# Price estimate

We base our estimate on net exterior wall surface (without openings). Though the final price can only be determined once the technical Panel Project is prepared, the first estimate tends to be very accurate.

The estimate includes the following items:

- » Preparation of the technical panel project
- » EcoCocon wall panels made to measure
- » Airtightness and assembly materials
- » Fibre board layer (optional)
- » Clay base coat and fine clay plaster (optional)

Every project is unique,  
all our panels are custom-made.

This cost estimate is for information only. To determine the final price, we need to work with your architect to prepare a detailed technical panel project.

Item	Amount	€/m <sup>2</sup>	Price ex. VAT
Panel Project	1		350,00 €
EcoCocon Straw Wall Panels	86 m <sup>2</sup>	150,00 €	12 900,00 €
Airtightness & Assembly Materials	86 m <sup>2</sup>	10,50 €	903,00 €
<b>Subtotal</b>			<b>14 153,00 €</b>
Wood Fibre Boards - 60 mm (optional)	94,6 m <sup>2</sup>	13,00 €	1 229,80 €
Clay Base Plaster & White Clay Finish (optional)	77,4 m <sup>2</sup>	11,00 €	851,40 €
<b>TOTAL (ex. VAT)</b>			<b>16 234,20 €</b>

Our delivery includes:

- ▶ The technical panel project (fully engineered)
- ▶ EcoCocon panels made to measure for your project and supplementary materials
- ▶ Just-in-time delivery of all the materials directly to the construction site
- ▶ 4 hours of free technical support for your architect and/or builder

Transport is calculated separately for each delivery. You can check the guide for approximate transport costs [here](#).

# Panel Project preparation

The Panel Project is the basic document for production and contains all the measures and types of panels required for the project at hand. It is prepared in cooperation with the architect and structural engineer and needs to be signed off by the parties involved.

**Note**

» For more information consult the Panel Project Preparation guide on [www.ecococon.eu/downloads](http://www.ecococon.eu/downloads)

ANNEXE No. 2  
 y 1 é g TCACA: S: AR  
 kg i l TCACA8AS8AR

**Panel Project**

BUYER NAME: \_\_\_\_\_ SELLER NAME: I i 999

ADDRESS: \_\_\_\_\_ MA

VAT CODE: \_\_\_\_\_ ROBAR h  
 E-MAIL/TEL.: \_\_\_\_\_ é  
 és CEBCACPRIKE  
[sales@ecococon.eu](mailto:sales@ecococon.eu)

Panel Type	Item	Qty.	Width (mm)	Height (mm)	Area (m <sup>2</sup> )	Angle	Notes
Panel [P]	yAB	BC	RAA	OMK	OK3R		
	yAC	B	SEK	OMK	C9C		
	yAD	B	BAAA	RVA	A9VM		
	yAE	B	BADR	OMK	C9P		
	yAK	C	MBS	OMK	D9A		
	yAM	B	MMA	OMK	BPM		
	yAP	M	EAA	OMK	MEA		
	yAR	D	KAA	OMK	E9A		
	yAS	B	SDK	OMK	C9S		
	yBA	B	SKA	OMK	C9D		
	yBB	B	ECAA	ERVA	C9D		
	yBC	B	BAAA	OMK	C9P		
	yBD	B	BECK	ERVA	C9B		
	yBE	B	BAKA	OMK	C9A		

1

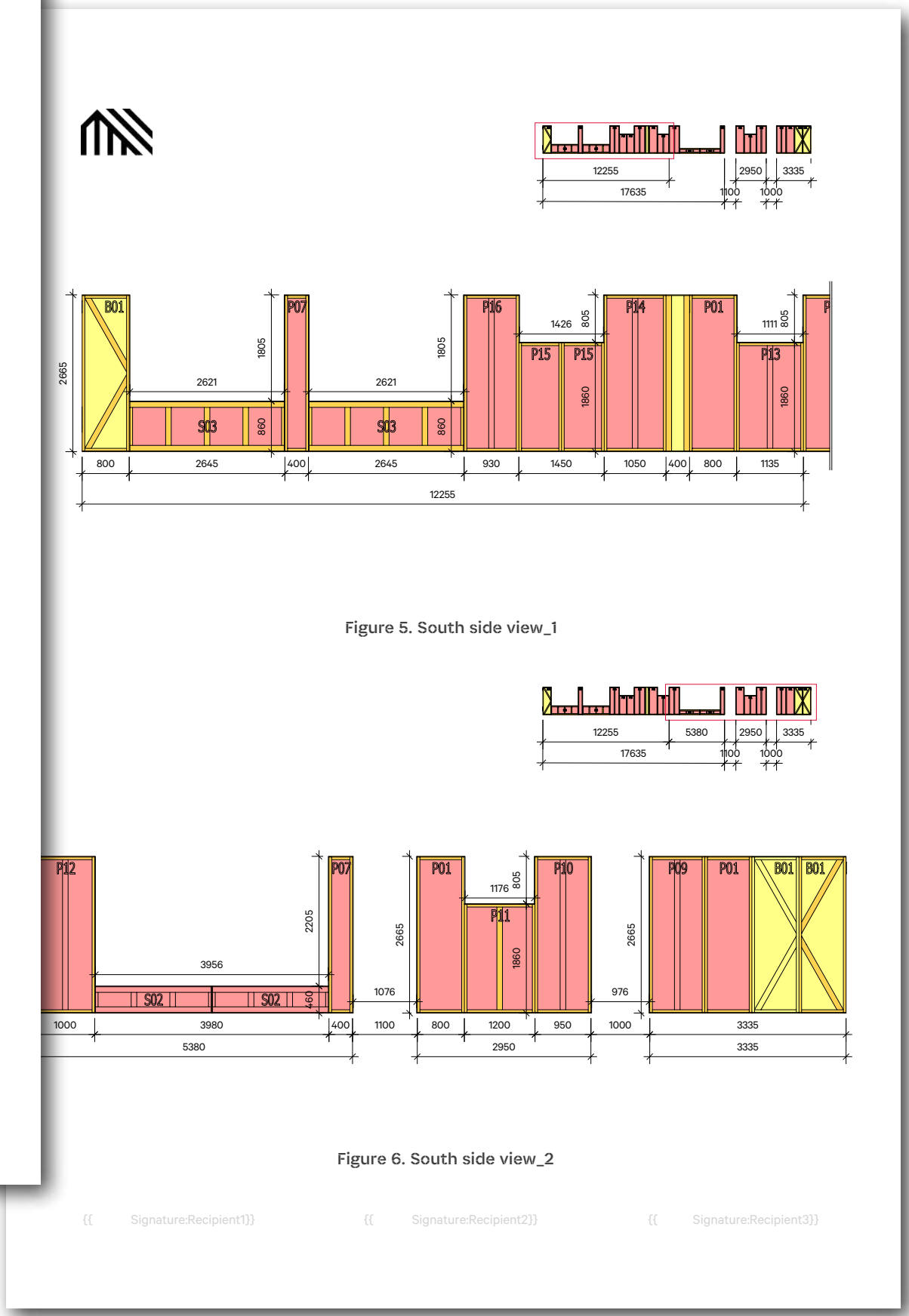



# Sales Order

The Sales Order specifies the amount and price for all materials delivered. To ensure exact order volumes, it is prepared only once the Panel Project is completed.

## Note

- » A customer can be a private person, a builder, developer or local partner.
- » If billed to a private customer who is not VAT registered, VAT will be included.
- » Payments go usually directly from customer to EcoCocon.

**eco**  **cocon**

**Sales Order**

**EcoCocon s.r.o.**  
Záhradnícka 60  
82108 Bratislava  
Slovakia  
Company ID: 52416151  
VAT No.: SK2121027854

Purchase Order by:

Order Date:

#	Item & Description	Qty	Rate	Amount
1	EcoCocon Standard Panels P	104,15 m <sup>2</sup>	130,00	13.539,50
2	EcoCocon Lintel Panel L	9,55 m <sup>2</sup>	160,00	1.528,00
3	LVL Box Lintels Special loadbearing lintels with less than 400mm height	4,88 m <sup>2</sup>	160,00	780,80
4	EcoCocon Sill Panel S	12,53	155,00	1.942,15
5	EcoCocon Column Panel C	5,49 m <sup>2</sup>	160,00	878,40
6	EcoCocon Braced Panels B	44,38 m <sup>2</sup>	140,00	6.213,20
7	Small size markup 1,6-1,7m <sup>2</sup>	180,98 m <sup>2</sup>	2,50	452,45
8	Panel project creation (up to 140m <sup>2</sup> )	1,00 pcs	350,00	350,00
9	Panel project (above 140m <sup>2</sup> ) Per m <sup>2</sup> above 140m <sup>2</sup>	40,98 m <sup>2</sup>	1,50	61,47
10	Plywood for Lintel support 21mm	19,00	16,00	304,00
11	LVL Beams LVL Beams for Box Lintels	0,60 m <sup>3</sup>	880,00	528,00

The electronic Declaration, Authorization and Trust Service regulation (eIDAS) qualifies the electronic signatures should be given the same legal effect as hand-written signatures. This law is valid in the twenty-eight member states of the European Union.

# Purchase Agreement

The purchase agreement is in English and it is signed through a secured electronic signature system, once the Detailed Offer and the Panel Project are approved.

## Note

- » The agreement is validated after receiving a 50% advance payment.





# Included in Offer: Inside view

## Standard

- » EcoCocon straw wall panels
- » Plywood boards (support for lintels)
- » Eurotec screws 6x60 (for plywood)
- » Eurotec screws 8x100
- » Eurotec screws 8x140
- » Eurotec screws 8x200

## Optional

- » Wood fibre boards 5 mm (on wood for clay plastering)
- » Brown base clay plaster
- » Fine white or coloured clay plaster

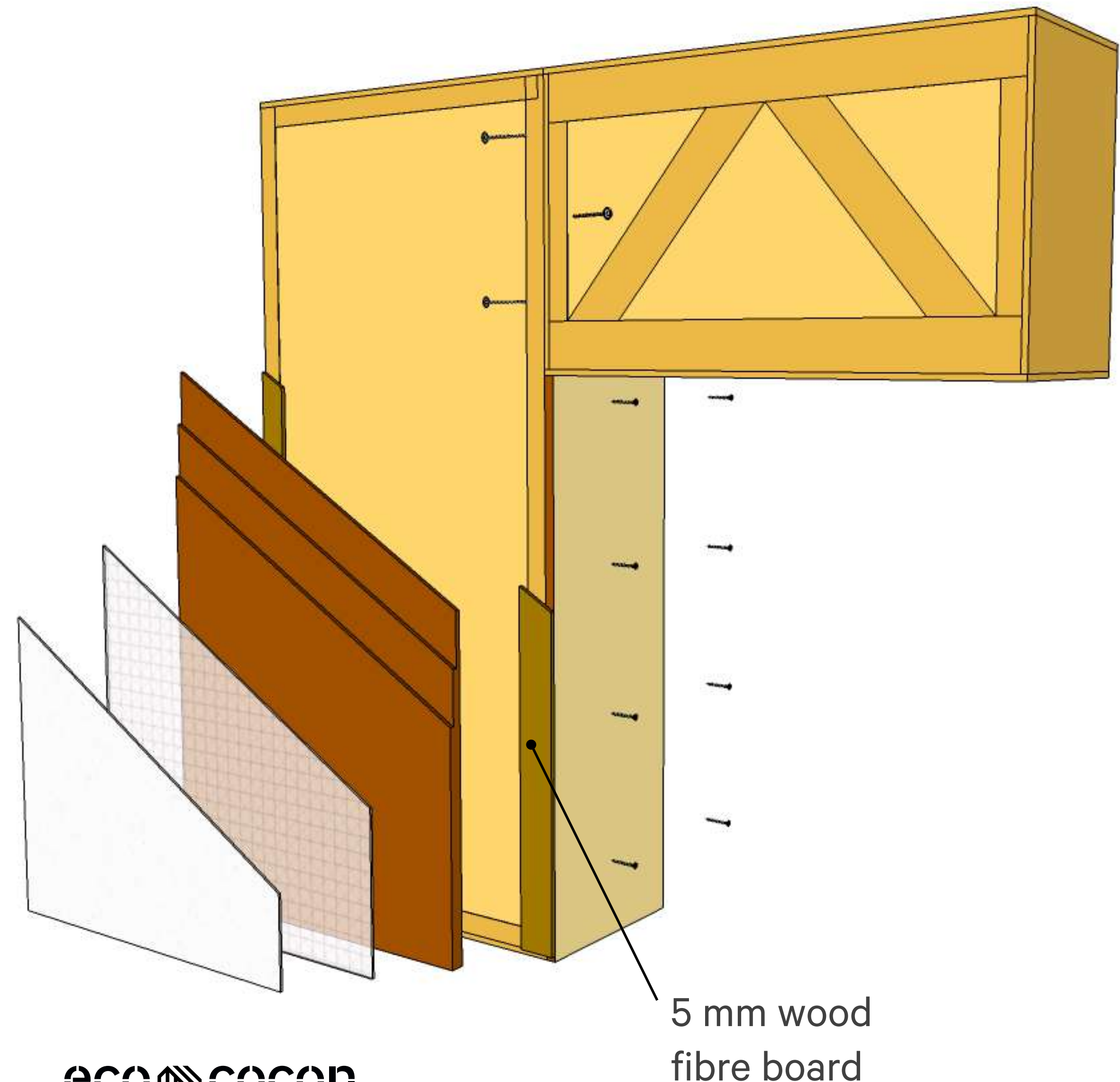

# Included in Offer: Outside view

## Standard:

- » Breathable membrane  $S_d < 0.2 \text{ m}$
- » Air sealing tape
- » Plywood 0.8 cm, strips 9.0 cm wide
- » Plywood 0.8 cm, strips 4.5 cm wide

## Optional:

- » Steico Protect 60 or 100 mm (or other available thickness)

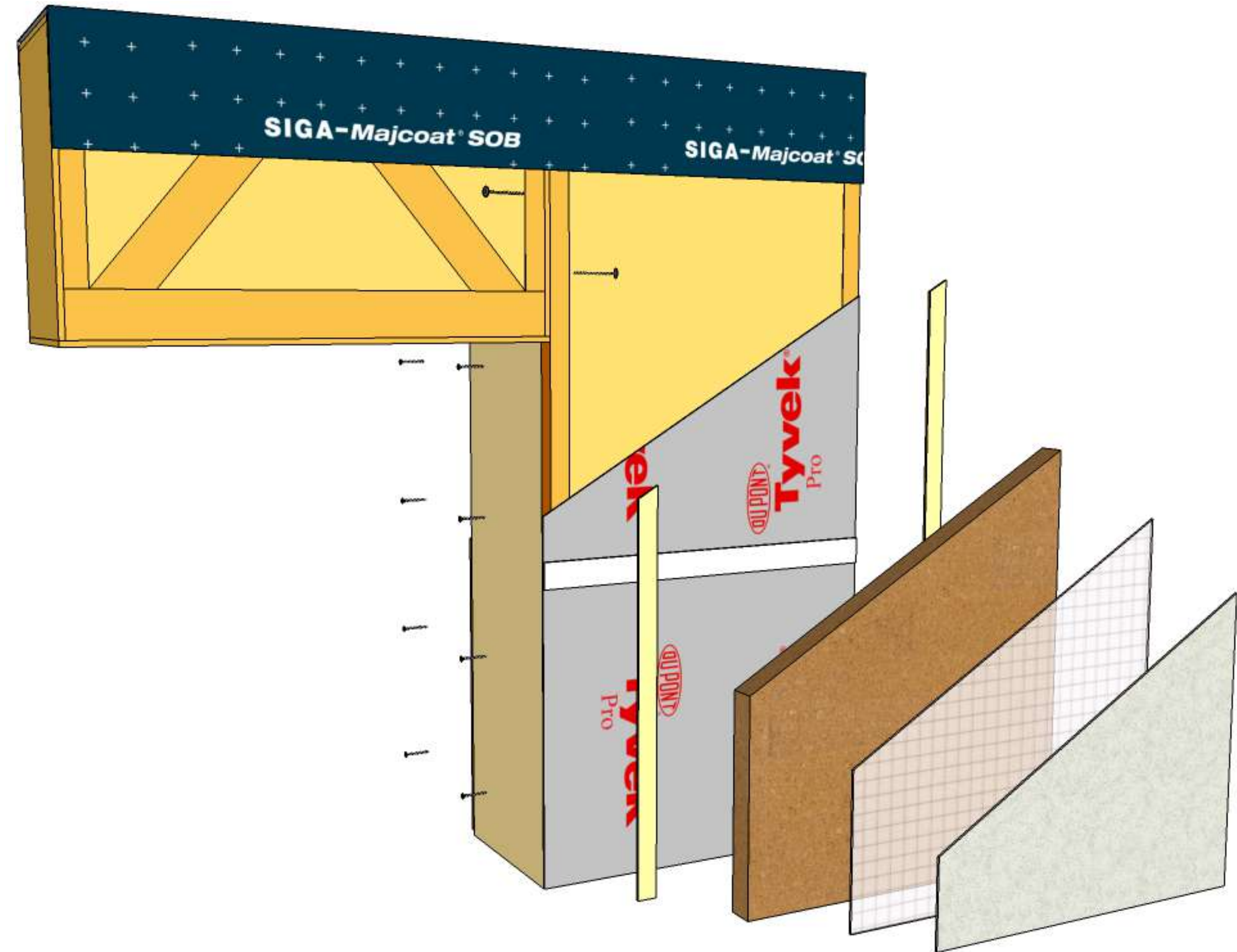



# Lead time

Every project is added to the production lineup on a first-come-first-served basis. The lead time can be **4 to 12 weeks** depending on the season.

The preliminary production date can only be established once the Panel Project is finalised.

We will agree on an exact delivery date before signing the contract.

## Note

- » We recommend ordering panels **at least 2 months** before expected wall mounting date for an average house size or **at least 4 months in advance** for larger projects.
- » Keep us updated, if you want to postpone the planned delivery date.

